



Installation Instructions

Call Station, 1 Button, Stainless 78-8028-9195-8

Call Station, No Button, Stainless 78-8028-9196-6

Backbox, Call Station, Stainless 78-8028-9192-5

Introduction

The stainless steel Call Station consists of a 3-1/2 inch, moisture-resistant, eight-ohm, speaker (78-8028-9179-2): an optional call switch: a special molded plastic speaker support panel: and a stainless front grill with louvers. The speaker/mic has a limited frequency response, equivalent to a horn-type speaker, for reduced low and high frequency noise pickup when used as a microphone. The grill and support design channels water away from the speaker for the best voice reproduction possible during wet weather conditions.

Use the Call Station with any 3M™ Wired Intercom where the application requires a combined speaker and microphone with an optional call switch to trigger the built-in alert for each station.

Recommended Call Station Cable

Use only twisted-pair, shielded, audio cable having at least 20 AWG wires to connect the intercom to the Call Station.

Mounting

Figure 1 shows the two basic methods of mounting the Call Station; **Flush-mounted** to a hole cut in the mounting surface, or **Surface-Mounted** using the optional stainless steel backbox.

Flush Mount

- Cut a 5-1/2 in. wide by 4-1/2 in. tall opening in the mounting surface.
- Fit the speaker support over the cutout and mark the two mounting hole locations.
- Using a #36 drill bit, drill the two holes for the #6-20x1" sheet metal screws (supplied).

Surface Mount Using Optional Stainless Backbox

- If using conduit, remove a hole plug from the rear or side.
- Hold the backbox against the mounting surface and mark the four mounting holes (and the cable hole if cable will exit rear of backbox).
- Drill four holes for the mounting hardware (not supplied) that you are using. Typical mounting hardware is #8 sheet metal screws and a #29 (0.0136 in. diameter) drill for pilot holes. Drill an appropriately sized (1 in. recommended) cable hole if the cable will exit the rear of the backbox.

WARNING: Do not route Call Station cables through the same conduit with 115 VAC electrical wiring. This violates the National Electrical Code and presents a safety hazard.

1. Route the speaker/mic and switch cables from the intercom to the speaker cutout or optional backbox, with about 12 inches of cable protruding.
2. Strip the two speaker cable wires and attach them to the two wires coming from the speaker/mic assembly.

3. Strip the switch cable wires, if used, and attach them to the wires coming from the switch assembly. Refer to the intercom installation instructions for specific wiring details.
4. Mount the stainless grill and speaker support using the two #6-20x1 in. sheet metal screws.
5. Fill the two mounting screw heads with epoxy to prevent theft.

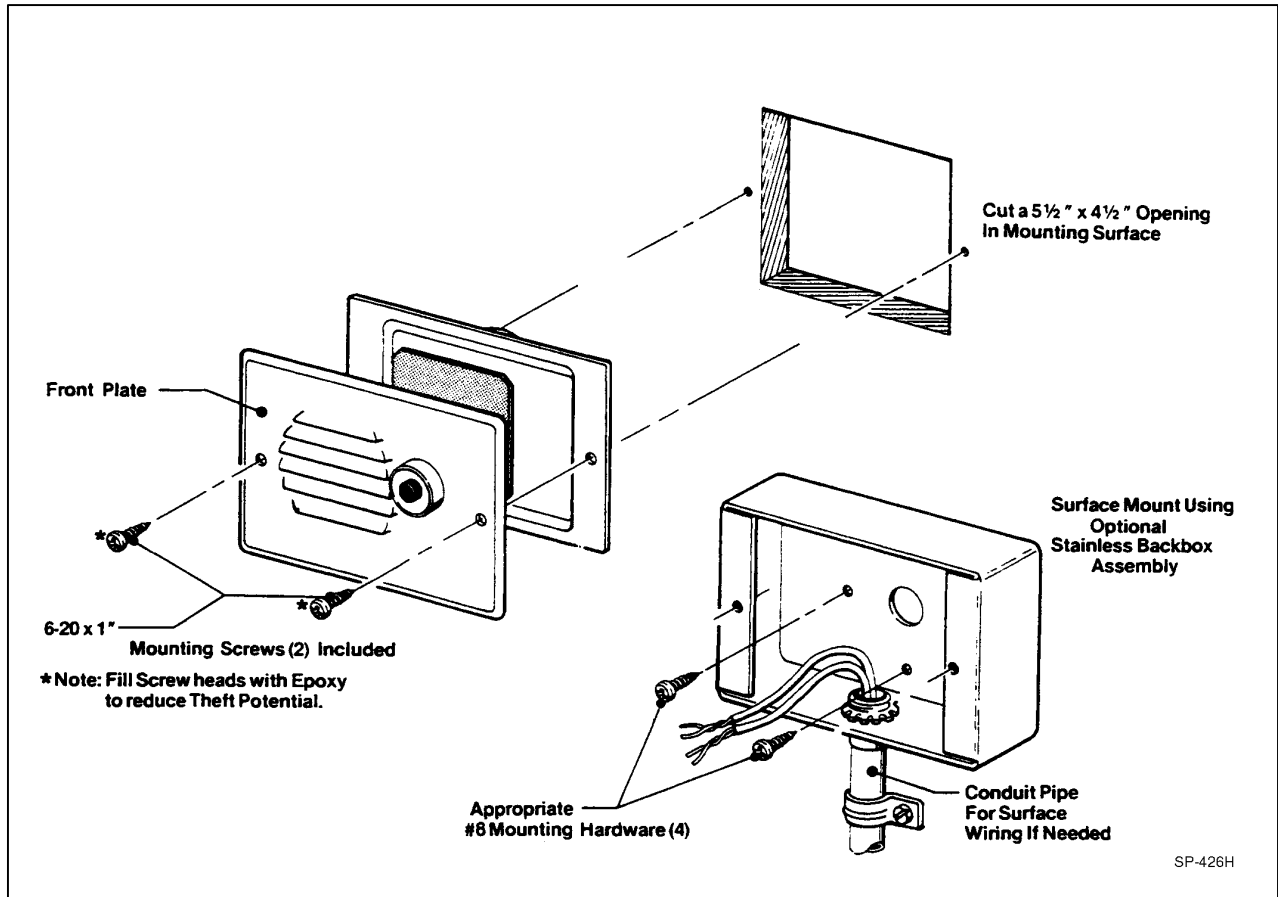

Figure 1 – Call Station Mounting Details

Note: mounting screws not available seperately.

Service Information

Most new installation problems result from overlooked instructions or wiring errors so recheck everything if an installation problem occurs. Be sure that this product is suitable for the device you are connecting it to.

Users should contact their local authorized 3M dealer for service on this product. For the name of your local 3M dealer, or repair or installation information, call **1-800-328-0033**.



Food Services Trade Department

3M Center
St. Paul, MN 55144-1000

©3M 2002 January

78-8028-9217-0 Rev G